

Stainless steel luminaire type 1803 type "MikroLux" for sterile operations

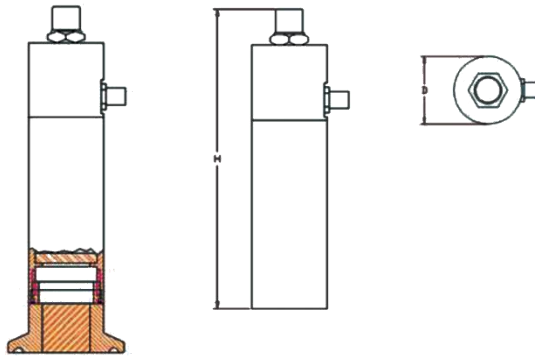

Applications

- Illumination of tanks, homogenisation mixers, laboratory plants, cauldrons, reactors etc. For usage in hygienic engineering (food processing, breweries, dairies, cosmetics and pharmaceutical industry). Particularly hygienic housing design. Electropolished stainless steel housing. No screws in the lid.

Operating conditions

- Independent of internal pressure in areas where there is no risk of explosion. Ambient temperature between -25°C to $+85^{\circ}\text{C}$

Material

- Material housing: AISI 304
- Surface housing: Fine turned e-polished

Advantages

- particularly small design
- easy maintenance due to connector
- Hygienic housing—electropolished
- O-ring sealed connecting adaptor
- External diameter 22 mm!

Operating

- The luminaire has a momentary switch with an o-ring sealed rubber boot.

Connecting cable

- Easy installation and maintenance due to plug and socket connection M5, including 3 metre cable as standard, 5 and 10 metre cable available on demand.

Operation Voltage

- Voltage: 12V or 24V AC or DC.
- Power: 5W, 10W, 20W or 100W, depending on operating voltage.

Options

- The connector is available as a 3-pole or 4-pole option model. With the 4-pole option model the switch and the bulb can be controlled separately. Via the switch a signal can be transmitted to a time relay or a controller, which control the bulb's burning time. This way a illuminated tank can be operated, without a hand being required to press the momentary switch.

MikroLux	Average lamp life**	Luminous flux	Switch*	Height
Power				
12 V 5 W	4000 h	60 lm	1	88 mm
12 V 10 W	4000 h	130 lm	1	88 mm
24 V 20 W	3000 h	300 lm	1	88 mm

* 1 = OFF—momentary

** XENON-bulb ca. 10.000h